

Cheat Card



- 1 Point to a single letter on each line, moving down the chart until the person gets **ONE** letter wrong
- 2 Move **TWO** lines up the chart and point to each letter on the line.
- 2 Keep pointing to each letter, moving down the chart, until the person gets **TWO** letters wrong on one line.
- 1 Write down the line number that is **ONE** above where you stopped.

Distance Vision Test
If they cannot see **line 7** on the distance chart, try **negative power Eyejusters** for distance vision.



Near Vision Test
If they cannot see **line 7** on the near vision chart, try **positive power Eyejusters** for near vision.

1. Clip the adjuster dial into the adjuster hole.
2. Put the glasses on and cover the eye you are not adjusting with your hand.
3. Rotate the adjuster dial all the way forward.
4. Rotate the adjuster dial backward until you can see the vision chart clearly.
5. Fine tune the lens by turning the dial forward a little until it just becomes unclear; then back slightly until it just becomes clear again.
6. Remove the dial and repeat for the other eye.

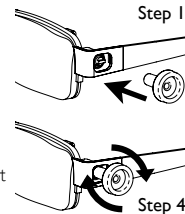

- Positive:** used by people who need glasses for near vision. Also used by people with long-sightedness for distance vision.
- Negative:** used by people with short-sightedness for distance vision.

Copyright © Eyejusters Ltd. All rights reserved.